

barkman™

Barkman Landscape Kits

Rosetta Dimensional Fire Pit

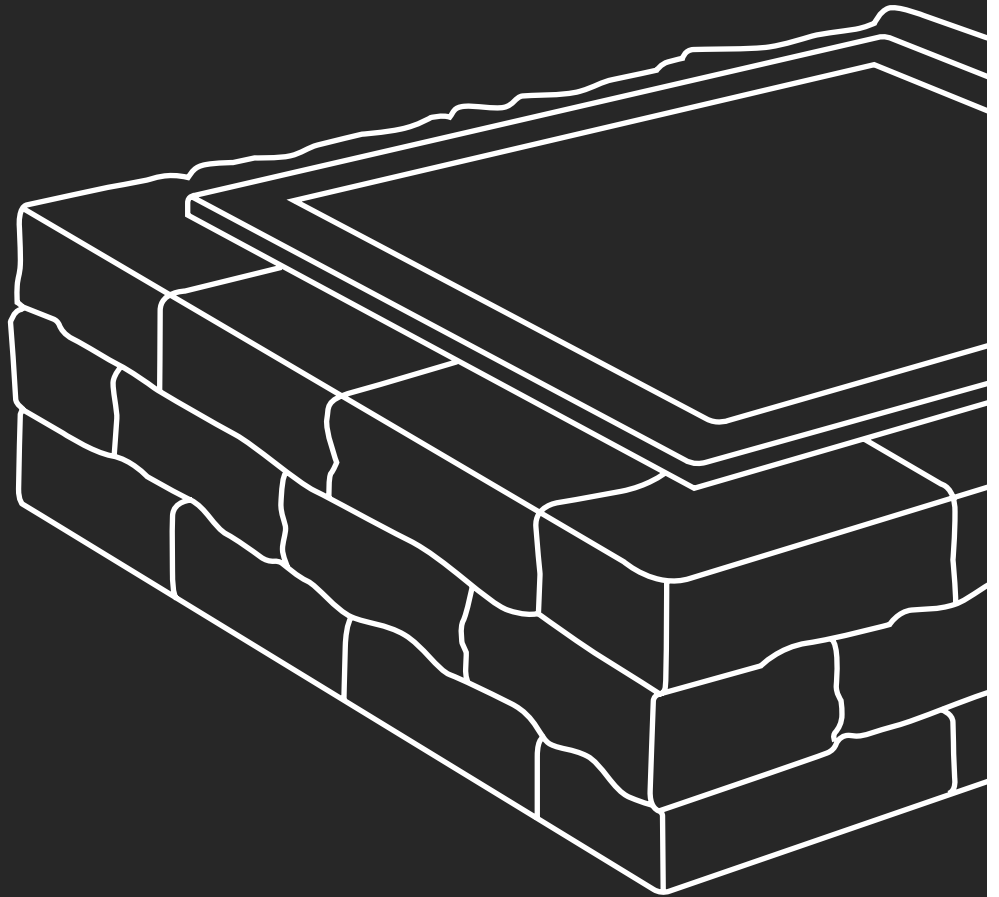

Materials

This kit measures 12" x 28" x 28" (inside)

MATERIALS INCLUDED:

- 4" x 12" Dimensional Wall – 42 pieces
- Spark Arrestor
- Steel Fire Pit Liner
- Gloves
- Instruction Guide

OTHER ITEMS NEEDED:

- Measuring Tape/Ruler
- Level

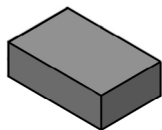

4 x 12
Dimensional Wall

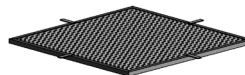

Spark
Arrestor

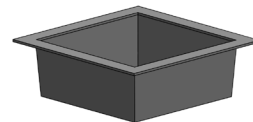

Steel Fire Pit
Liner

Base Preparation

For installation on an unstructured base, please follow these steps:

1. Mark out the location for your fire pit. Excavate area approx. 5" below grade.
2. Excavate approx. 6" larger than your actual kit dimensions to ensure a stable base
3. Fill 4" with 3/4" limestone and compact.
4. Level out 1" of sand and install kit as per the instruction guide.

For installation on a solid base such as an existing patio:

1. Once installed, insulate the patio from the fire using all-purpose sand or rock to fill in the fire pit.
2. Base prep and excavation is not necessary. Proceed to Step 1.

Read Prior to Installation

REGULATIONS

1. The consumer is responsible for reviewing the local regulations pertaining to the installation and use of this product. Please confirm that use of this product is in compliance with the by-laws, regulations, building codes and laws of your jurisdiction before using.
2. Locate your respective gas lines, wires, water pipes, and/or any above ground and underground services in your area. Install your Barkman fire pit kit the proper distance away from them. Check with your provider for location and distance requirements prior to installation.
3. Check with your insurance provider concerning the installation, use, value implications and/or any other considerations in regard to your fire pit.

LONG TERM USE

1. Barkman wall blocks are not fire-rated and are not covered under the Barkman warranty. It is the customer's responsibility to ensure that the wall blocks are adequately protected. Firebricks or a fire pit liner are recommended to improve the integrity of the product.

2. Barkman fire pit liners will eventually rust after prolonged fire exposure. An oil-based rust paint spray can be used for added protection or after rust occurs.
3. This fire pit is not suitable for large fires. Do not allow flame to contact the top layer. Fire pits should not be placed directly on concrete as high heat can adversely affect the integrity of the product.

Instructions

- A** Place and center Steel Fire Pit Liner on prepared base.
- B** Place three alternating layers as shown using Dimensional Wall Straight blocks.
- C** Check that stones are level. The steel liner should hang directly on the blocks.
- D** Place the spark arrestor on top of the steel liner.

Note: The spark arrestor and liner retain heat long after use. Ensure both are cool before touching.

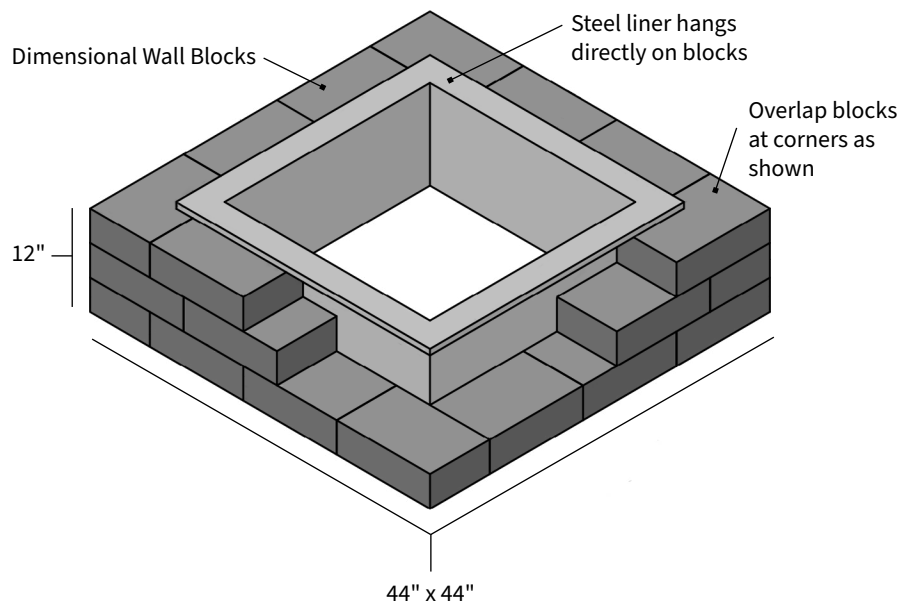

barkman™

STEINBACH OFFICE

152 Brandt Street, Steinbach, MB R5G 0R2
T 204 326 3445 or 1 800 461 2278
F 204 326 5915
Steinbach@BarkmanConcrete.com

WINNIPEG OFFICE

901 Gateway Road, Winnipeg, MB R2K 3L1
T 204 667 3310 or 1 800 342 2879
F 204 663 4854
Winnipeg@BarkmanConcrete.com

CALGARY OFFICE

813 McCool Street, Box 1136,
Crossfield, AB T0M 0S0
T 403 946 4630 F 403 946 4631
Calgary@BarkmanConcrete.com

VANCOUVER OFFICE

2104-290 Newport Drive,
Port Moody, BC V3H 5N2
T 778 689 7670 or 1 800 461 2278
F 604 949 0321
Vancouver@BarkmanConcrete.com

SASKATOON DISTRIBUTION CENTER

3550 Idylwyld Drive North, Saskatoon, SK
T 1 306 549 7544

KELOWNA DISTRIBUTION CENTER

1904 Old Okanagan Highway, Westbank, BC
T 1 204 346 9490

SURREY DISTRIBUTION CENTER

8157 132nd Street, Surrey, BC
T 1 204 346 9490

BARKMAN CONCRETE LIMITED

BarkmanConcrete.com

