

**barkman™**

Barkman Landscape Kits

# Quarry Stone Fire Pit

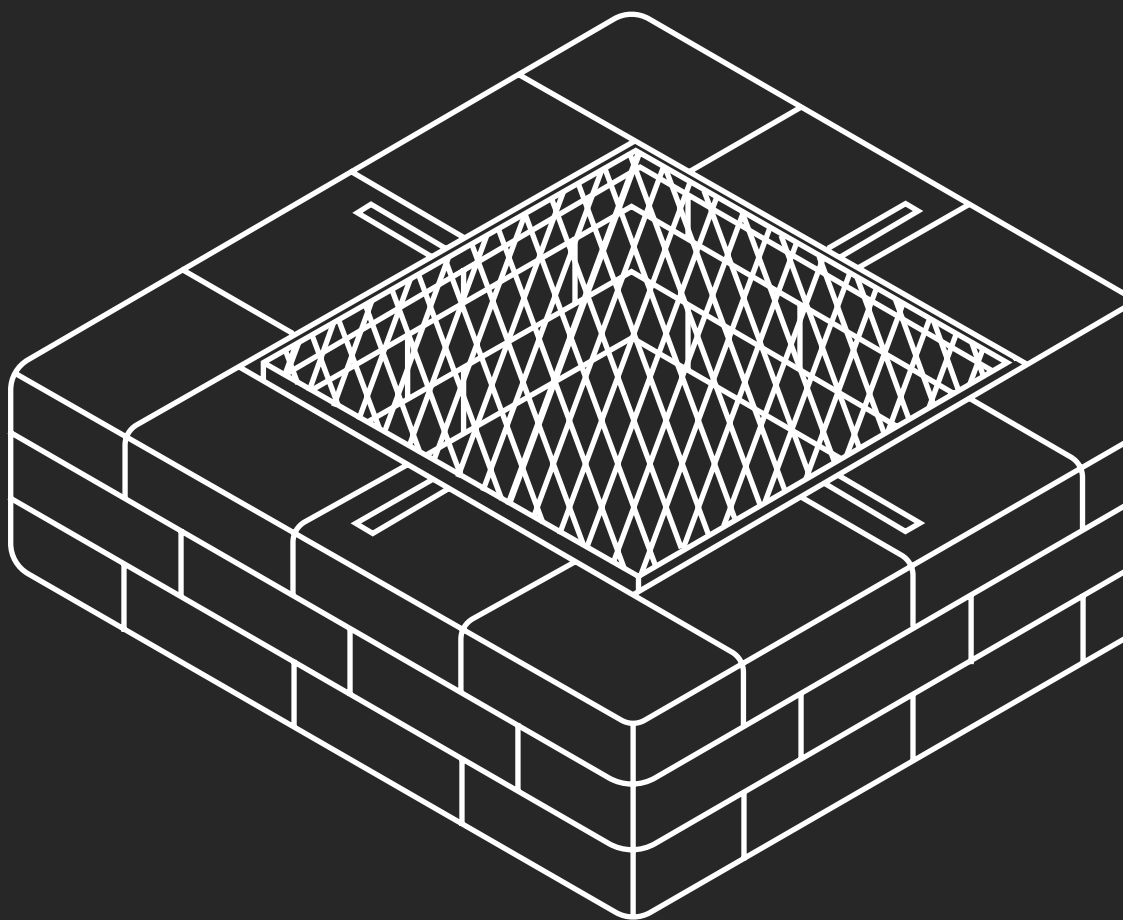

# Materials

This kit measures 12 x 28 x 28 (inside)

## MATERIALS INCLUDED:

- 12" x 8" Quarry Stone – 36 pieces
- Spark Arrestor
- Gloves
- Instruction Guide

## SOLD SEPARATELY :

- Steel Fire Pit Liner

## OTHER ITEMS NEEDED:

- Measuring Tape/Ruler
- Level

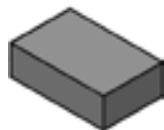

12 x 8  
Quarry Stone



Spark  
Arrestor



Steel Fire Pit  
Liner (Sold Separately)

# Base Preparation

## For installation on an unstructured base, please follow these steps:

1. Mark out the location for your fire pit. Excavate area approx. 5" below grade.
2. Excavate approx. 6" larger than your actual kit dimensions to ensure a stable base
3. Fill 4" with 3/4" limestone and compact.
4. Level out 1" of sand and install kit as per the instruction guide.

## For installation on a solid base such as an existing patio:

1. Once installed, insulate the patio from the fire using all-purpose sand or rock to fill in the fire pit.
2. Base prep and excavation is not necessary. Proceed to Step 1.

# Read Prior to Installation

## REGULATIONS

1. The consumer is responsible for reviewing the local regulations pertaining to the installation and use of this product. Please confirm that use of this product is in compliance with the by-laws, regulations, building codes and laws of your jurisdiction before using.
2. Locate your respective gas lines, wires, water pipes, and/or any above ground and underground services in your area. Install your Barkman fire pit kit the proper distance away from them. Check with your provider for location and distance requirements prior to installation.
3. Check with your insurance provider concerning the installation, use, value implications and/or any other considerations in regard to your fire pit.

## LONG TERM USE

1. Barkman wall blocks are not fire-rated and are not covered under the Barkman warranty. It is the customer's responsibility to ensure that the wall blocks are adequately protected. Firebricks or a fire pit liner are recommended to improve the integrity of the product.

2. Barkman fire pit liners will eventually rust after prolonged fire exposure. An oil-based rust paint spray can be used for added protection or after rust occurs.
3. This fire pit is not suitable for large fires. Do not allow flame to contact the top layer. Fire pits should not be placed directly on concrete as high heat can adversely affect the integrity of the product.

# Instructions

---

## 1

**A** On your selected location, lay out the first layer using pattern A.

**B** Ensure that this layer is level to allow for a proper installation.

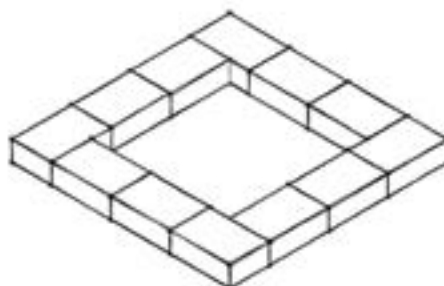

**USE:**

(12) Quarry Stone blocks

---

## 2

**A** The second layer uses pattern B, which is offset from the previous pattern.

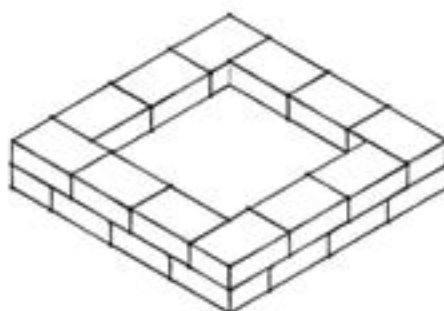

**USE:**

(12) Quarry Stone blocks

---

## 3

**A** Repeat the pattern from Step 1 as shown in the diagram.

**B** (Optional) If a Steel Fire Pit Liner was purchased, install in center of fire pit.

**C** Place Spark Arrestor on top of Quarry Stone or Steel Fire Pit Liner.

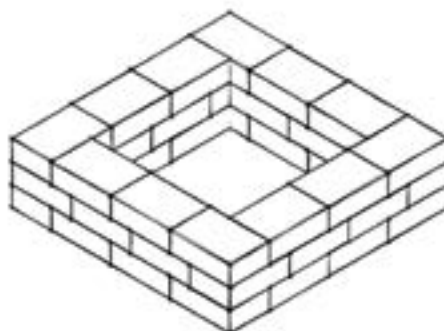

**USE:**

(12) Quarry Stone blocks  
Spark Arrestor

**Note:** The spark arrestor and liner retain heat long after use. Ensure both are cool before touching.

# barkman™

## STEINBACH OFFICE

152 Brandt Street,  
Steinbach, MB R5G 0R2  
T 204 326 3445 or 1 800 461 2278  
F 204 326 5915  
Steinbach@BarkmanConcrete.com

## WINNIPEG OFFICE

901 Gateway Road,  
Winnipeg, MB R2K 3L1  
T 204 667 3310 or 1 800 342 2879  
F 204 663 4854  
Winnipeg@BarkmanConcrete.com

## CALGARY OFFICE

813 McCool Street, Box 1136,  
Crossfield, AB T0M 0S0  
T 403 946 4630  
F 403 946 4631  
Calgary@BarkmanConcrete.com

## VANCOUVER OFFICE

Port Moody, BC  
T 1 800 461 2278  
F 604 949 0321  
Vancouver@BarkmanConcrete.com

## MERRITT OFFICE

1132 Middy Valley Road  
Merritt, BC V1K 1M9  
T 778 661 1408

## SASKATOON DISTRIBUTION CENTER

3550 Idylwyld Drive North,  
Saskatoon, SK S7L 6G3  
T 1 800 461 2278

**BARKMAN CONCRETE LIMITED**

[BarkmanConcrete.com](http://BarkmanConcrete.com)

